

No. of Courses	Courses up Loyalhanna Creek	Distances
1	S. 80. E. 30	
2	S. 64. E. 50	
3	S. 54. E. 38	
4	N. 80. E. 20	
5	N. 68. E. 38	
6	East 20	
7	N. 33 40	
8	N. 22. E. 34	
9	N. 68. E. 30	
10	S. 79. E. 28	
	total dist.	328

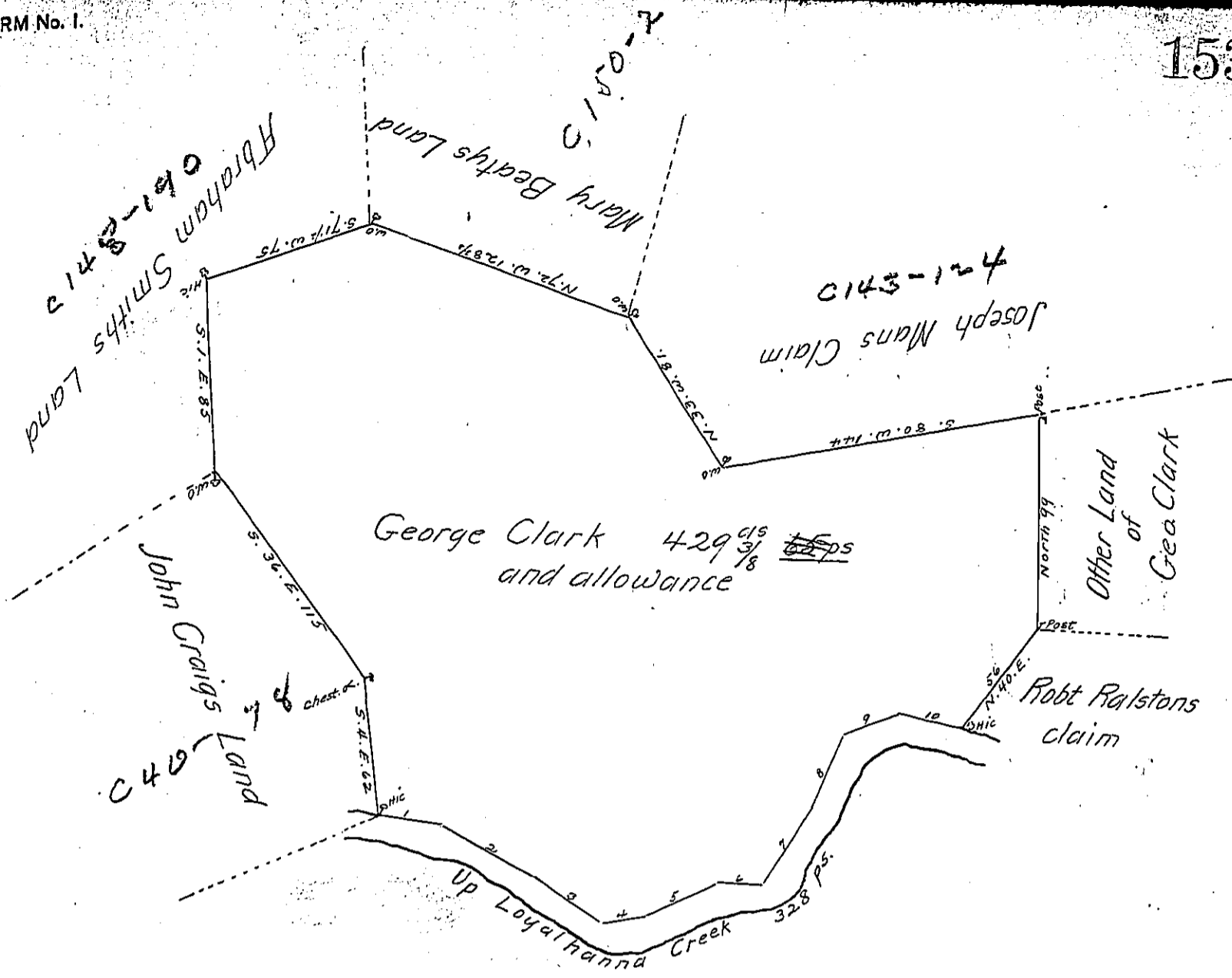

In pursuance of a Warrant dated Feby. 8th. 1785 was Survey'd for George Clark the above described Tract of Land Containing Four Hundred and Twenty nine acres and Sixty five perches with an allowance proportioned to six pCent Situate on the East side of Loyalhanna Creek adjoining Land of Joseph Man and others in Derry Township Westmoreland County Survey'd June 2nd. 1787.

p. John Moore D.S.

To John Lukens Esqr. Survr. Genl.

IN TESTIMONY that the above is a copy of the original remaining on file in the Department of Internal Affairs of Pennsylvania, made conformably to an Act of Assembly approved the 16th day of February, 1833, I have hereunto set my Hand and caused the Seal of said Department to be affixed at Harrisburg, this twentieth day of February 1904

James R. Parsons
Secretary of Internal Affairs.